

SWISHER OWNER'S/OPERATOR'S MANUAL

E4-U3004 MULTIPURPOSE EDGER TOOL

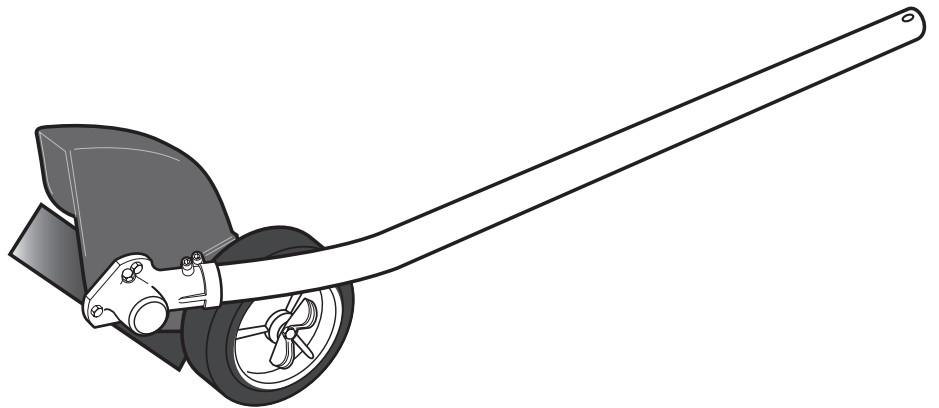

WARNING!

Always wear eye protection when operating this machine. To minimize the risk of injury, read this manual and familiarize yourself with its contents.

SWISHER

Part Number 65033-94310 Rev. 12/07

Introduction

The Swisher E4-U3004 Multipurpose Edger Tool is designed and built to deliver superior performance and reliability without compromise to quality, comfort, safety or durability.

As an owner/operator, you'll soon discover for yourself why Swisher is simply in a class by itself!

IMPORTANT!

The information contained in these instructions describes components available at the time of publication.

While every attempt has been made to provide the latest information about your Swisher product, there may be some differences between your attachment and what is described here. Swisher reserves the right to make changes to products without prior notice and without obligation to make alterations to components previously manufactured.

Attention statements

Throughout this manual are special "Attention Statements".



WARNING!

A statement preceded by the triangular attention symbol and the word "WARNING" contains information that should be acted upon to prevent serious bodily injury.

CAUTION!

A statement preceded by the word "CAUTION" contains information that should be acted upon to prevent mechanical damage.

IMPORTANT!

A statement preceded by the word "IMPORTANT" is one that possesses special significance.

NOTE:

A statement preceded by the word "NOTE" contains information that is handy to know and may make your job easier.



Read and follow this manual, make sure anyone using the trimmer does likewise. Failure to do so could result in serious personal injury or machine failure. Keep this manual for future reference.



Always wear a hard hat to reduce the risk of head injuries during operation of this machine. In addition, always wear eye and hearing protection. Swisher recommends wearing a face shield as additional face and eye protection.

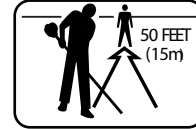

Keep bystanders at least 50 feet (15 meters) away during operation.



Beware of ricocheted or thrown objects.

Contents

PAGE

Attention statements	2
Safety precautions	3
Safety labels	3
General safety instructions	5
Product description.....	6
Specifications.....	6
Assembly	7
Installing a tool attachment.....	8
Removing a tool attachment.....	8
Operating	9
Maintenance	10
Troubleshooting Guide	11

IMPORTANT!

The procedures described in this manual are intended to help you get the most from your unit as well as to protect you and others from harm. These procedures are guidelines for safe operation under most conditions, and are not intended to replace any safety rules and/or laws that may be in force in your area. If you have questions regarding your E4-U3004, or if you do not understand something in this manual, contact Swisher Inc. at (800) 222-8183, or go to www.swisherinc.com for assistance. You may also contact Swisher at the address printed on the back of this Manual.

Safety precautions



WARNING!

Never operate this tool or any other power equipment if you are tired, ill, or under the influence of alcohol, drugs, or any substance that could affect your ability or judgement.



Work Safely

An edger tool has the potential to do serious damage if misused, abused or mishandled. To reduce the risk of injury, you must maintain control at all times, and observe all safety precautions during operation. Never permit a person without training or instruction to operate this machine!

NOTE

For specific maintenance and safety information about the Multipurpose Edger Tool powerhead, consult the operator's/owner's manual provided with that product. If it has been lost or misplaced, contact Swisher at the telephone number provided on the back cover of this manual for a replacement.



WARNING!

Operating Precautions

- This Swisher edger tool is specifically designed for use on the Swisher Multipurpose Tool Carrier. Installation and/or use on any other model, brand or type of power tool is not approved by Swisher. Attempts to use on non-approved models can damage the equipment and cause accidents, serious injury or death.
- Always make sure the Multipurpose Edger Tool is properly installed and firmly tightened before operation.
- Make sure there is always good ventilation when operating this machine. Fumes from engine exhaust can cause serious injury or death. **Never run the engine indoors!**
- Never use a cracked or warped cutting attachment: replace it with a serviceable one and make sure it fits properly.
- Stop the machine immediately if it suddenly begins to vibrate or shake. Inspect for broken, missing or improperly installed parts or attachments.
- Never smoke or light fires near the engine. Fuel is very flammable and fire could lead to serious personal injury or property damage.
- Make sure there are no missing or loose fasteners, and that the stop switch and throttle controls are working properly.
- Never make unauthorized attachment installations.
- Before starting the engine, make sure the cutting attachment is not contacting anything.
- Always stop the engine immediately and check for damage if you strike a foreign object or if the machine becomes tangled. Do not operate with broken or damaged equipment.
- Never transport the machine or set it down with the engine running. An engine that's running could be accidentally accelerated causing the cutting attachment to rotate.
- Make sure cutter safety guards are in place when transporting the machine.

Safety labels

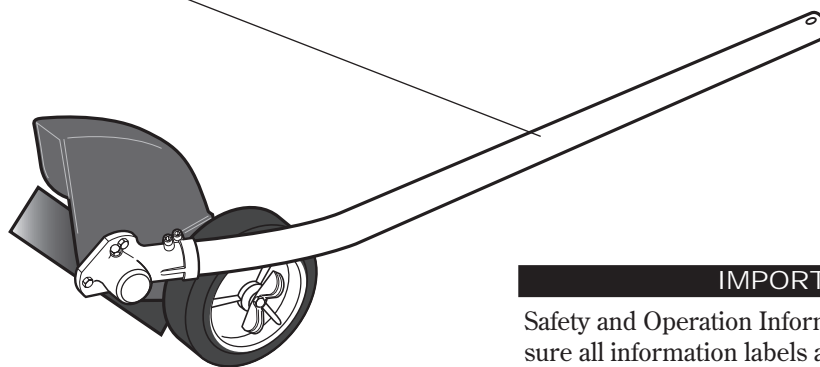

IMPORTANT

Safety and Operation Information Labels: Make sure all information labels are undamaged and readable. Immediately replace damaged or missing information labels. New labels are available. Contact Swisher Inc. at (800) 222-8183, or go to www.swisherinc.com for assistance .

Figure 1

The properly equipped operator

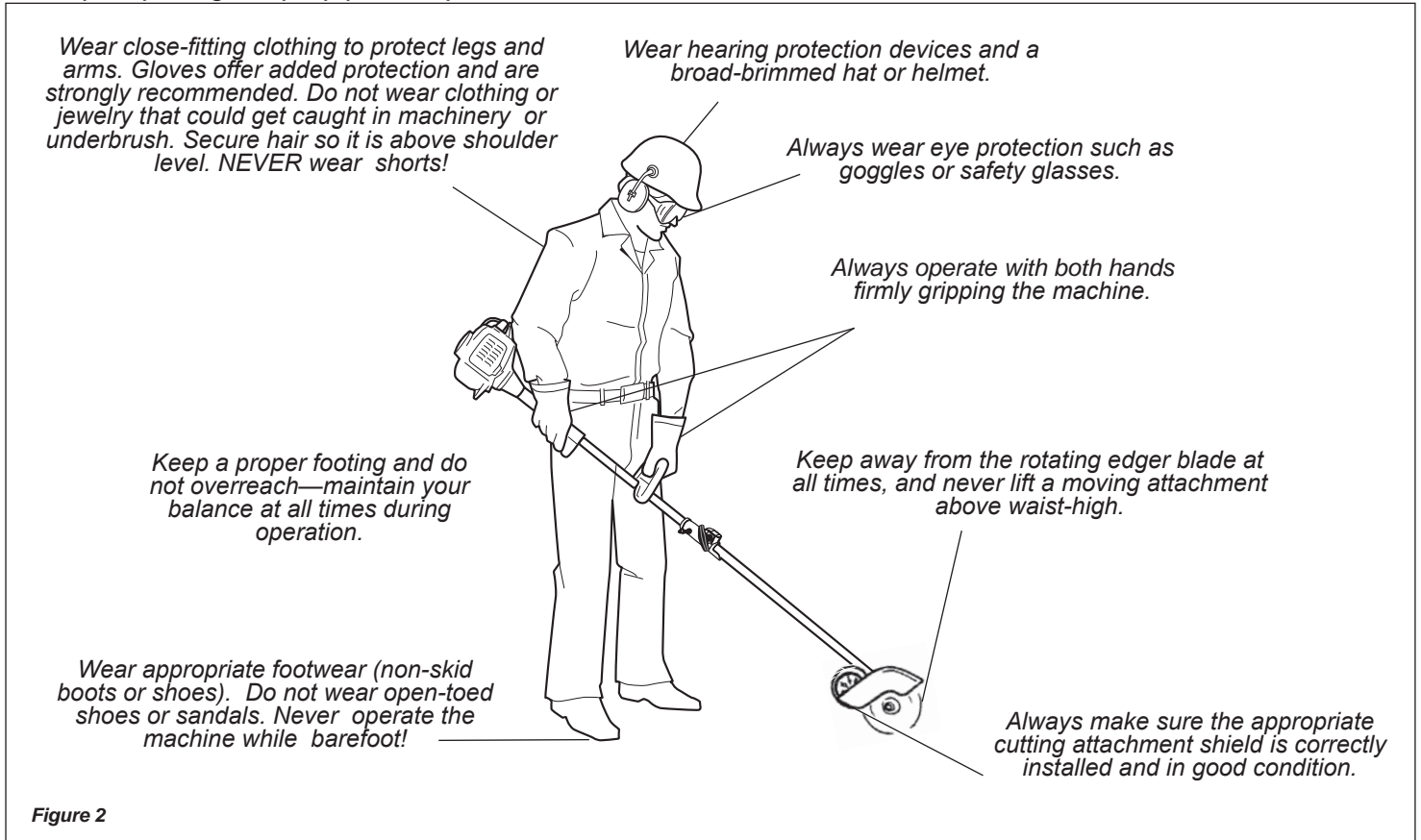

Figure 2

Be aware of the working environment

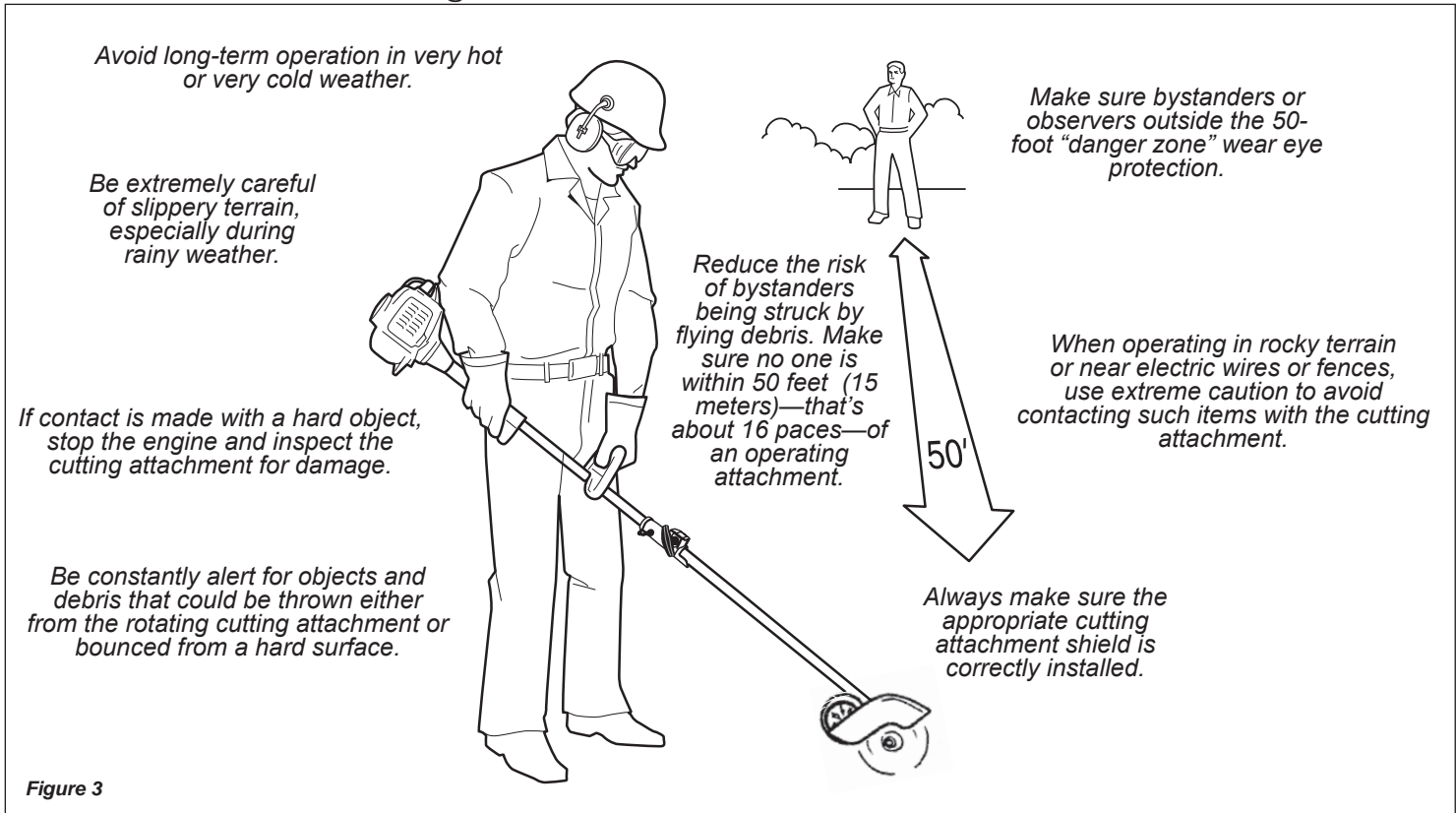

Figure 3

General safety instructions



WARNING! Minimize the Risk of Fire

- Never smoke or light fires near the edger.
- Always stop the engine and allow it to cool before refueling. Avoid overfilling and wipe off any fuel that may have spilled.
- Always move the unit to a place well away from a fuel storage area or other readily flammable materials before starting the engine. Use caution when handling fuel. Move the power tool at least 10 feet (3 meters) from the fueling point before starting the engine.
- Never place flammable material close to the engine muffler.
- Never run the engine without the spark arrester screen in place. Do not operate the machine with the muffler removed.



WARNING!
Use Good Judgment

ALWAYS wear eye protection to shield against thrown objects.

ALWAYS protect yourself from hazards such as thorny brush and flying debris by wearing gloves and close fitting clothing that covers arms and legs. Never wear shorts. Don't wear loose clothing or items such as jewelry that could get caught in machinery or underbrush. Secure long hair so it is above shoulder level.

NEVER run the engine indoors! Make sure there is always good ventilation. Fumes from engine exhaust can cause serious injury or death.

ALWAYS clear your work area of trash or hidden debris that could be thrown back at you or toward a bystander.

ALWAYS use the proper cutting tool for the job.

ALWAYS stop the machine immediately if it suddenly begins to vibrate or shake. Inspect for broken, missing or improperly installed parts or attachments.

ALWAYS hold the machine firmly with both hands when edging and maintain control at all times.

ALWAYS keep the handles clean.

ALWAYS disconnect the spark plug wire before performing any maintenance work.

ALWAYS keep the unit as clean as practical. Keep it free of loose vegetation, mud, etc.

Product description

Using this illustration as a guide, familiarize yourself with your machine and its various components. Understanding your machine helps ensure top performance, long service life, and safer operation.

Multipurpose Edger Tool

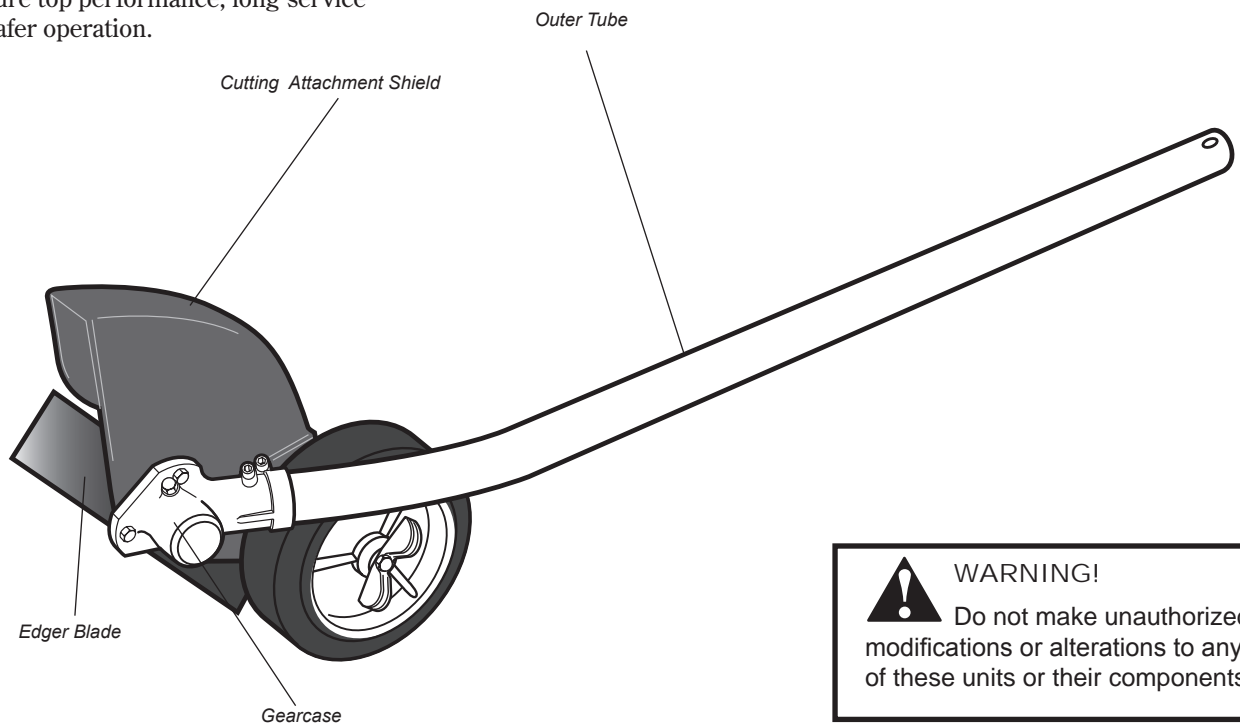

Figure 4

WARNING!
Do not make unauthorized modifications or alterations to any of these units or their components.

Specifications

Multipurpose Edger Tool (less cutting attachment)	4.9 lbs. (2.2 kg)
Gearcase Lubrication	Lithium based grease (Swisher 13-57)
Gear Reduction.....	1.36:1
Gearcase Arbor Bolt Size	8 mm Left-hand thread

*Specifications are subject to change without notice.

Assembly

Prior to assembly

Before assembling, make sure you have all the components required for a complete unit:

- Outer Tube/Main Shaft Assembly
- Cutting Attachment Shield
- Edger Blade

- Kit containing cutting attachment shield, mounting bracket and hardware, this owner's/operator's manual, and a tool kit for routine maintenance.

Carefully inspect all components for damage.

IMPORTANT!

The terms "left", "left-hand", and "LH"; "right", "right-hand", and "RH"; "front" and "rear" refer to directions as viewed by the operator during normal operation.

Mounting the cutting attachment shield and edger blade

Cutting attachment shield

1. Remove the shaft bolt, bolt guard, holder A and holder B from the gearcase. See Figure 5.
2. Align the cutting attachment shield assembly with the gearcase as shown, and then fit the shield onto the matching flange on the gearcase. See Figure 5.



WARNING!

The edger is intended for right-handed operation only! When correctly assembled, the cutting attachment shield and shaft must be oriented as shown.

3. Install the socket-head screws with washers, then use the hex wrench to firmly tighten all three screws. See Figure 6.
4. Install a washer and nut on each of the three screws assembled in Step 3, then firmly tighten each nut.

IMPORTANT!

The three socket-head screws must be firmly tightened against the cutting attachment shield before installing and tightening the nuts.

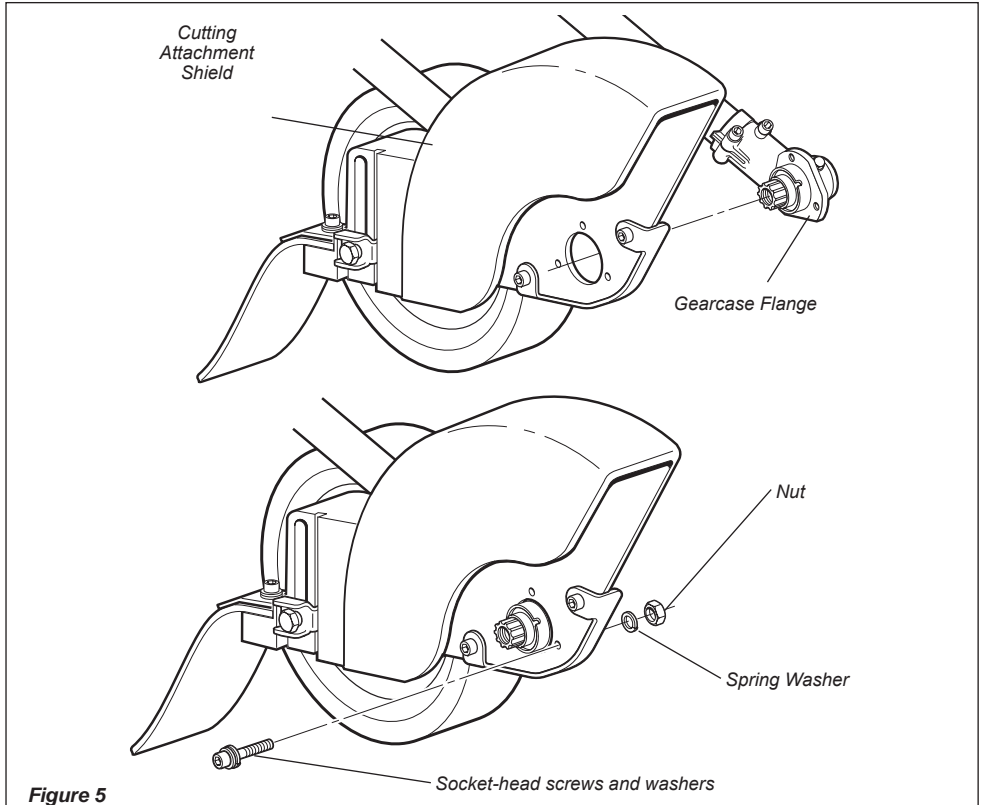

Figure 5

Mount the Edger Blade

1. Install the holder A onto the output shaft. See Figure 6.
2. Mount the edger blade and holder B onto the output shaft, and then install the bolt guard and shaft bolt (turn bolt counter-clockwise to install). See Figure 6.
3. Align the hole in holder A with the matched hole in the gearcase, and then use the hex wrench to temporarily lock the output shaft. See Figure 6.
4. Use the combination wrench to firmly tighten the shaft bolt. Remove the hex wrench. See Figure 6.

The Multipurpose Edger Tool should now be completely assembled.



WARNING!

- The edger is designed for use with an edger blade only!
- Never operate the edger without the cutting attachment shield installed and tightly secured!

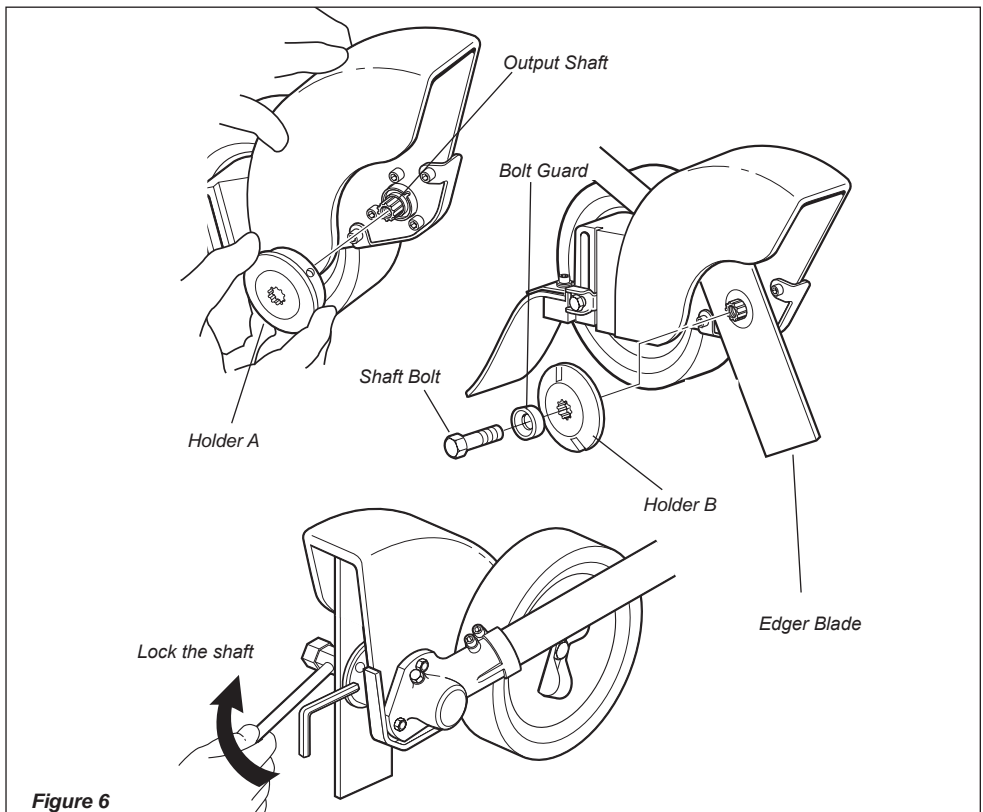

Figure 6

Installing a tool attachment

1. Place the engine assembly and the edger tool assembly on a clean, flat surface so that both assemblies fit end to end.

The engine assembly should be facing up and the tool assembly should be positioned with the locking hole in the tube end facing up. See Figure 7

CAUTION!

Keep the open ends of the tubes clean and free of impurities!

2. Slip off the protective covers from the ends of both tubes, and loosen the coupler screw knob.
3. Insert the tool assembly into the coupler, with the tool decal facing up, until the line of the decal is flush with the end of the coupler.
4. Twist the tool assembly back and forth until you are sure it snaps in place by the coupler latch. See Figure 7.
5. When the two tube halves are locked together, press down on the spring-loaded latch protector and tighten the coupler screw knob. See Figure 8.

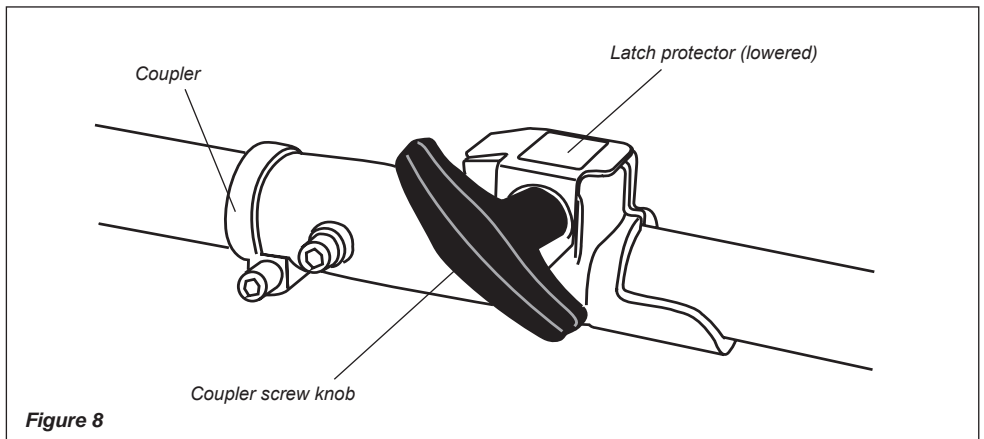
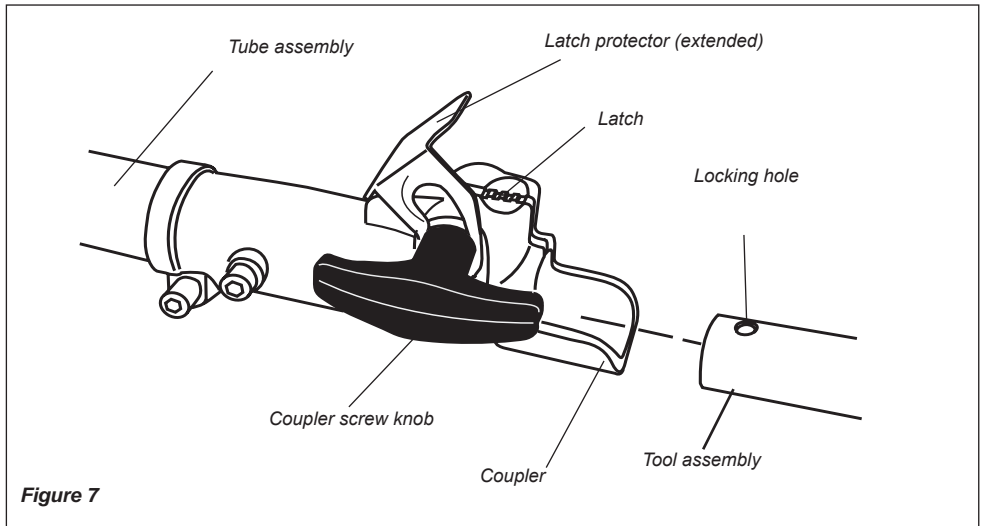

Removing a tool attachment

1. With the unit on a clean, flat surface, loosen the coupler screw. The spring-loaded coupler protector should pop up.
2. Press down on the latch with your finger or thumb. This releases the coupler lock. See Figure 9.
3. Pull the tool assembly out of the coupler.

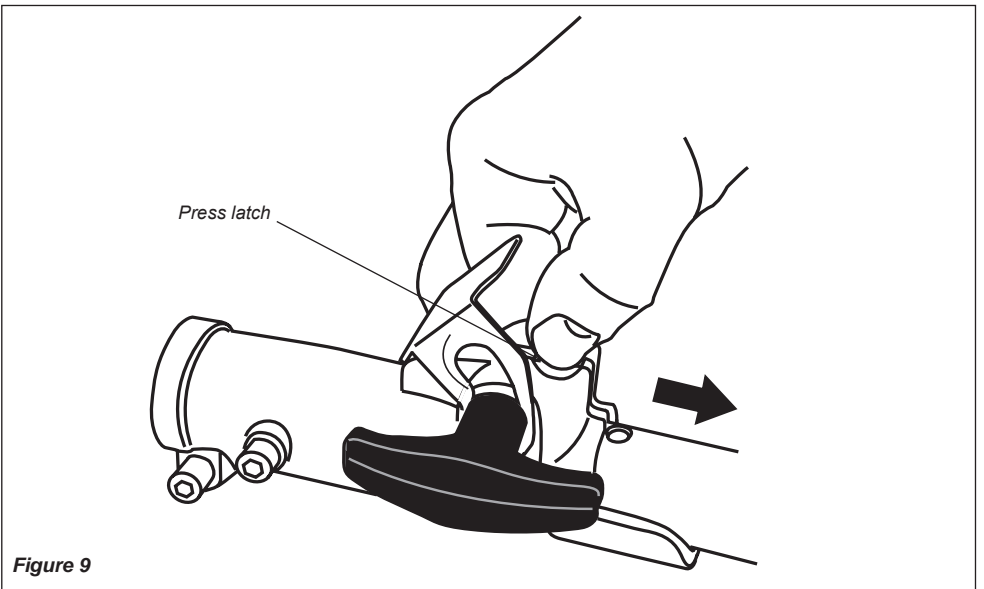

Operating

Checking unit condition

NEVER operate the unit with the cutting attachment shield or other protective devices (ignition switch, etc.) removed!

Use only authorized Swisher parts and accessories with your edger tool. Do not make modifications to your machine without the written approval of Swisher.

ALWAYS make sure the cutting attachment is properly installed and firmly tightened before operation.

NEVER use a cracked or warped edger blade: replace it with a serviceable one.

ALWAYS make sure the edger blade fits properly into the appropriate cutter holder. If a properly installed attachment vibrates, replace the attachment with new one and re-check.

NEVER operate a machine with worn or damaged fasteners or attachment holders.

ALWAYS stop the engine immediately and check for damage if you strike a foreign object or if the machine becomes tangled. Do not operate with broken or damaged equipment.

NEVER allow the engine to run at high RPM without a load. Doing so could damage the engine.

WARNING!
A cutting attachment shield or other protective device is no guarantee of protection against ricochet. **YOU MUST ALWAYS GUARD AGAINST FLYING DEBRIS!**

Using a hand-held edger

WARNING!

- Wear eye protection, long pants, and boots when operating this machine!
- Whenever you strike a hard object with the blade, always stop the edger and carefully inspect the blade for damage. **NEVER OPERATE THE EDGER WITH A DAMAGED BLADE!**

- Before edging, make sure the area is soft enough so the blade does not bog down. If necessary, water the area before edging.
- Remove debris and other obstacles that could be thrown by the rotating blade.

- Plan your work so the edger blade is always on your right-hand side.
- Begin each pass by positioning the unit over the work, and with the engine running at about half-throttle. Slowly lower the blade to the ground while applying full throttle. See Figure 10.
- Do not move the edger into the work so fast that the engine or blade bogs down.
- Regular and frequent use of the edger will make a neater lawn, and a frequently trimmed edge will be easier to maintain.

CAUTION!
Low-speed edging can lead to premature clutch failure.



Figure 10

Adjusting blade cutting depth

The edger's depth of cut is controlled by a combination of operator height, blade wear, and the positioning of the edger's guide wheel.

To adjust blade height:

- Loosen the guide wheel adjusting knob. See Figure 11.
- Raise or lower the guide wheel to the desired setting. See Figure 11a.
- Tighten the guide wheel adjusting knob firmly. See Figure 11.

WARNING!
Use only Swisher replacement edger blades.

WARNING!
Never adjust the guide wheel while the engine is running.

NOTE:
Guide wheel adjustment is also required to compensate for blade wear.

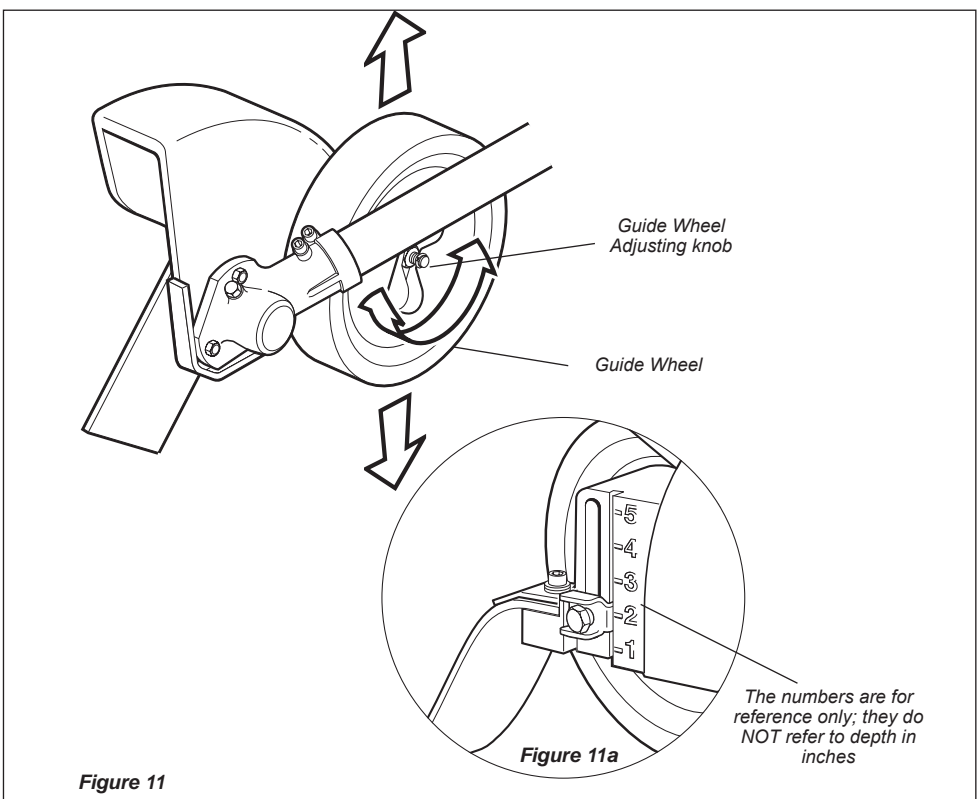

Figure 11

Maintenance

Engine maintenance

IMPORTANT!

For detailed maintenance information about your Multipurpose Tool, consult the owner's manual that was provided with it. If it has been lost or misplaced, contact Swisher for a replacement.

NOTE:

Using non-standard replacement parts could invalidate your Swisher warranty.



WARNING!

Before performing any maintenance, repair, or cleaning work on the unit, make sure the engine and cutting attachment are completely stopped. Disconnect the spark plug wire before performing service or maintenance work.



WARNING!

Non-standard parts may not operate properly with your unit and may cause damage and lead to personal injury.

Daily maintenance

Prior to each work day, perform the following:

- Carefully remove any accumulations of dirt or debris from the muffler and fuel tank. Dirt build-up in these areas can lead to engine overheating, fire, or premature wear.
- Check for loose or missing screws or components.
- Check the entire machine for leaking fuel or grease.
- Make sure that nuts, bolts, and screws (except carburetor adjusting screws) are tight.

Edger Blades

Check the edger blades condition frequently. If an edger blade's performance changes suddenly, stop the engine and check the blade for cracks or other damage. Replace a damaged edger blade IMMEDIATELY!



WARNING!

Never repair a damaged edger blade by welding, straightening, or by modifying its shape. An altered edger blade may break during operation, resulting in serious personal injury.



WARNING!

- The Multipurpose Edger Tool is designed for use with a single, bar-type blade only.
- Blades are not interchangeable between Swisher edgers and brushcutter models. Operating any machine with a blade or attachment not approved for that unit can be hazardous and may cause serious injury.

50-hour Maintenance

- Remove the shaft bolt, bolt guard, holder A, blade, holder B, and the output shaft collar. Press new grease into the gearcase until the old grease has been pushed out. Use only lithium-base grease such as Swisher Gearcase Lubricant or equivalent. See Figure 12.

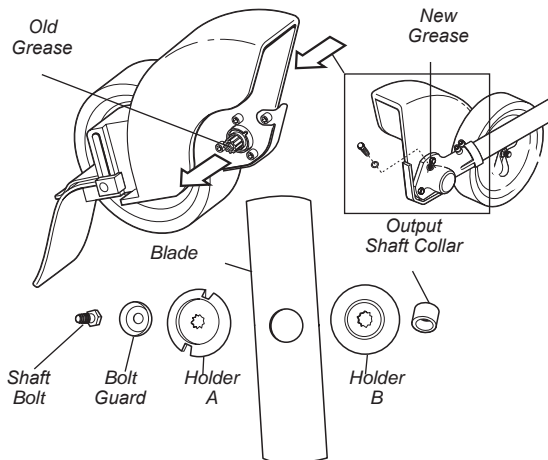

Figure 12

Lubricate the Flexible Shaft

Lack of lubrication will cause rapid wear to the flexible shaft and also to the shaft tube liner, resulting in increased vibration and greatly decreased service life. Remove and lubricate the flexible shaft as follows: See Figure 13.

1. With the unit on a clean, flat surface, loosen the coupler screw knob. The spring-loaded coupler protector should pop up.
2. Press down on the latch with your finger or thumb. This releases the coupler lock. Refer to the section "Removing a tool attachment".

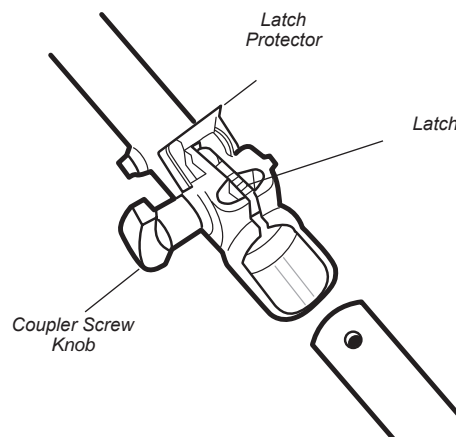

Figure 13

Maintenance (continued)

50-hour Maintenance (Cont)

3. Pull the tool assembly out of the coupler.
4. Pull the flexible shaft and bushing from the shaft tube assembly. See Figure 14. Clean the shaft thoroughly in solvent and dry with a clean shop towel.
5. Inspect the flexible shaft carefully, and replace if worn or damaged.
6. Coat the entire length of the shaft with a premium gearcase lubricant.
7. Reinstall the flexible shaft.
8. Reinstall the bushing. Push it into the outer tube until it bottoms against the collar on the flexible shaft.

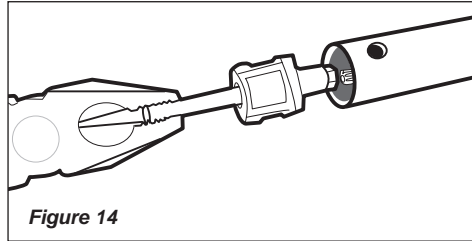

Figure 14

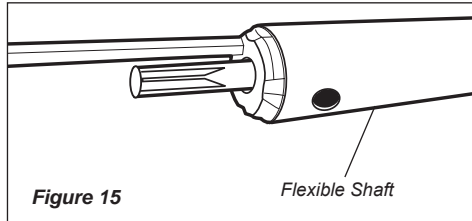

Figure 15

Flexible Shaft

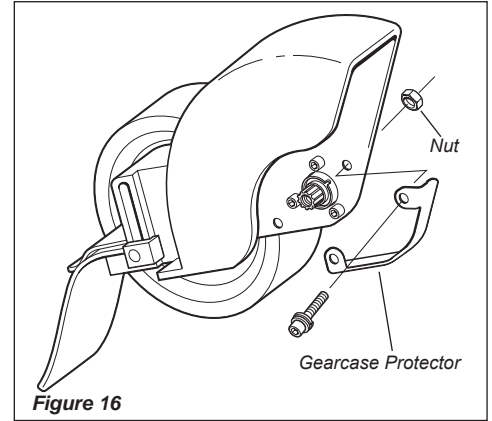

Figure 16

Gearcase Protector

Inspect the Gearcase Protector

The metal gearcase protector is installed to protect the gearcase flange from damage when working close to sidewalks or other abrasive surfaces, and should be routinely inspected for damage or excessive wear. See Figure 15.

When replacing the protector, inspect to be sure that both of the protector mounting screws are firmly tightened and each screw is locked in place with a nut as shown in Figure 16.

NOTE

Always replace the liner if the flexible shaft is being replaced.

Troubleshooting Guide

ADDITIONAL PROBLEMS

What To Check	Possible Cause	Remedy
<div style="border: 1px solid black; padding: 5px; width: fit-content;"> Cutting attachment oscillates at engine idle. </div>	<ul style="list-style-type: none"> Engine idle too high. Broken clutch spring or worn clutch spring boss. Loose attachment holder. 	<ul style="list-style-type: none"> Set idle: 2,750 (\pm250) min-1. Replace spring/shoes as required, check idle speed. Inspect and re-tighten holders securely.
<div style="border: 1px solid black; padding: 5px; width: fit-content;"> Excessive vibration. </div>	<ul style="list-style-type: none"> Warped or damaged attachment. Loose gearcase. Bent main shaft/worn or damaged bushings. 	<ul style="list-style-type: none"> Inspect and replace attachment as required. Tighten gearcase securely. Inspect and replace as necessary.
<div style="border: 1px solid black; padding: 5px; width: fit-content;"> Attachment will not oscillate. </div>	<ul style="list-style-type: none"> Shaft not installed in powerhead or gearcase. Broken shaft. Damaged gearcase. 	<ul style="list-style-type: none"> Inspect and reinstall as required. Consult with a authorized servicing dealer.

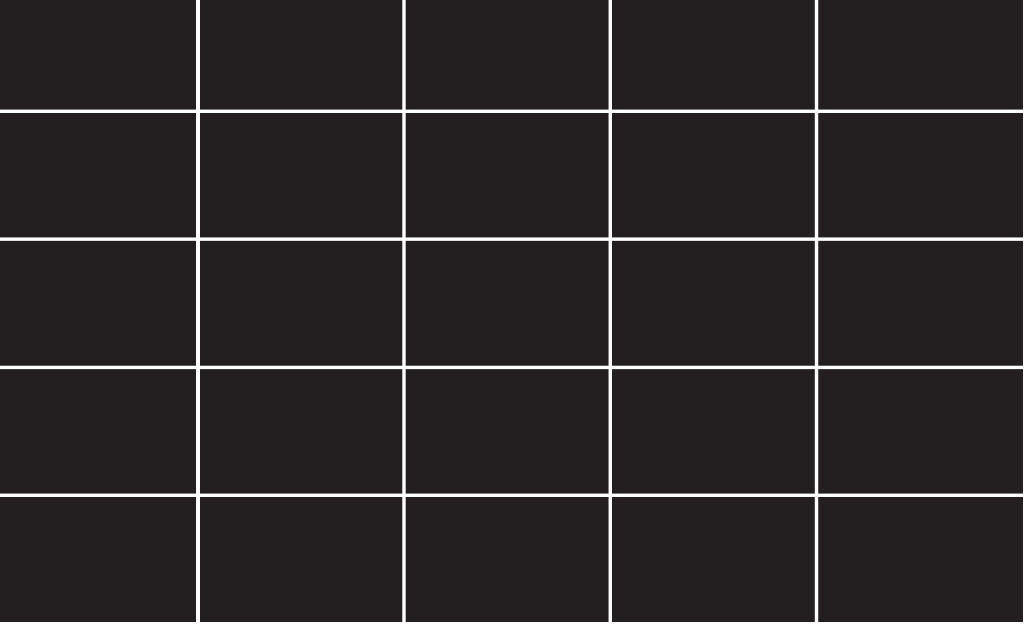

Swisher Inc.
P.O Box 67
Warrensburg, MO 64093

©2007 Swisher, Inc.
Part Number 65033-94310
Rev. 12/07
Specifications subject to change without notice.