

SWISHER

MANUFACTURING QUALITY LAWN CARE EQUIPMENT SINCE 1945

Owner's Manual

**Manual Lift
2828**



IMPORTANT
*Read and follow all
Safety Precautions
and Instructions
Before Operating this
Equipment.*

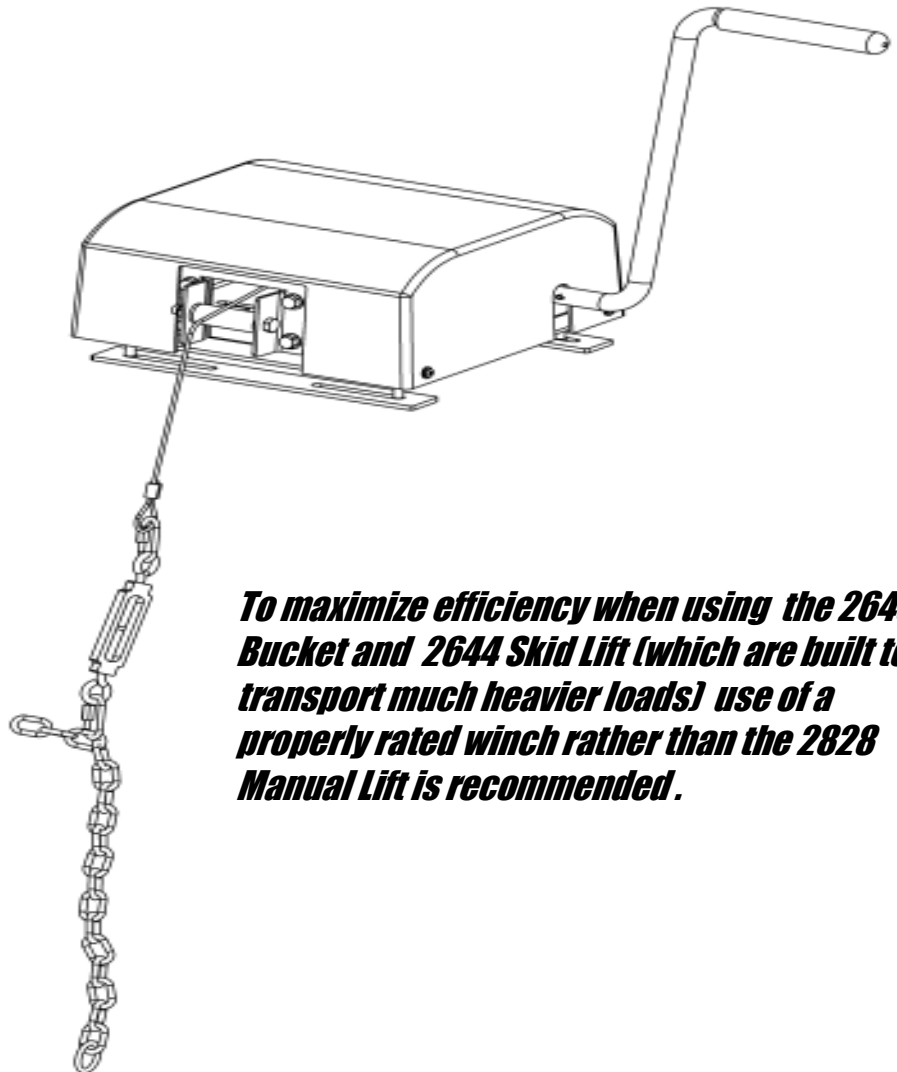

***To maximize efficiency when using the 2643
Bucket and 2644 Skid Lift (which are built to
transport much heavier loads) use of a
properly rated winch rather than the 2828
Manual Lift is recommended.***



**ASSEMBLY
OPERATION
SERVICE AND ADJUSTMENT
REPAIR PARTS**

Made In The
USA

1602 CORPORATE DRIVE PO BOX 67 WARRENSBURG, MISSOURI 64093
PH 660. 747. 8183 FAX 660. 747. 8650
swisherinc.com

LIMITED WARRANTY

The manufacturer's warranty to the original consumer purchaser is: This product is free from defects in materials and workmanship for a period of one (1) year from the date of purchase by the original consumer purchaser. We will repair or replace, at our discretion, parts found to be defective due to materials or workmanship. This warranty is subject to the following limitations and exclusions:

- 1) Commercial Use The warranty period for any product used for commercial or rental is limited to ninety (90) days from the date of original purchase.

- 2) Limitations This warranty applies only to products which have been properly assembled, adjusted, and operated in accordance with the instructions contained within this manual. This warranty does not apply to any product of Swisher Mower Co., Inc., that has been subject to alteration, misuse, abuse, improper assembly or installation, or shipping damage.

- 3) Exclusions Excluded from this warranty are normal wear, normal adjustments, and normal maintenance.

In the event you have a claim under this warranty, you must return the product to an authorized service dealer. All transportation charges, damage, or loss incurred during transportation of parts submitted for replacement or repair under this warranty shall be borne by the purchaser. Should you have any questions concerning this warranty, please contact us toll-free at 1-800-222-8183. The model number, serial number, date of purchase, and the name of the authorized Swisher dealer from whom you purchased the product will be needed before any warranty claim can be processed.

THIS WARRANTY DOES NOT APPLY TO ANY INCIDENTAL OR CONSEQUENTIAL DAMAGES AND ANY IMPLIED WARRANTIES ARE LIMITED TO THE SAME TIME PERIODS STATED HEREIN FOR ALL EXPRESSED WARRANTIES.

Some states do not allow the limitation of consequential damages or limitations on how long an implied warranty may last, so the above limitations or exclusions may not apply to you. This warranty gives you specific legal rights and you may have other rights, which vary from state-to-state. This is a limited warranty as defined by the Magnuson-Moss Act of 1975.

Never make adjustments or repairs to lift with the ATV engine running.

SAFETY PRECAUTIONS & DECALS



This Safety Alert Symbol indicates important messages in this manual. When you see this symbol, carefully read the message that follows and be alert to the possibility of personal injury.

Read this manual completely. Failure to observe the following safety instructions could result in serious injury or death.

- Read the manual. Learn to operate this machine safely.
- Keep the ATV operating speed **LOW!!!!** Do not operate over 5 MPH (8KMH)
- Allow only responsible adults who are familiar with these instructions to operate this machine. Never allow children to operate this machine.
- Be sure the area is clear of other people before operating. Children are often attracted to the machine and the operating activity. ***Never assume that children will remain where you last saw them.*** Keep children under the watchful care of another responsible adult.
- Watch for traffic when operating near or crossing roadways.
- Do not operate any accessory mounted to lift, if it has been dropped or damaged in any manner. Repair as necessary.
- Dress properly. Do not operate when barefoot or wearing open sandals.
- Do not operate the machine while under the influence of alcohol or drugs.
- Never tamper with safety devices. Check their proper operation regularly.

INSTALLATION AND OPERATION OF MANUAL LIFT



TO ENSURE PROPER INSTALLATION, CAREFULLY FOLLOW ALL INSTRUCTIONS LISTED BELOW

1. Mount handle to the lever weldment. Secure with roll pin. Slide handle grip over handle (Applying soap to inside of grip may improve ease of assembly).
2. Mount lift to the front ATV rack using mounting brackets, 5/16" carriage bolts, 5/16" washer, and 5/16" Nyloc nuts. The lift needs to be mounted in the center of the rack. Position of the mounting brackets needs to be determined by the end user depending on the type of ATV and rack the lift is being mounted to.
3. Construct the cable assembly using chain connectors, cable, turnbuckle and adjustment chain. **Note: The turnbuckle should have the eyebolts extended out to allow for final adjustment of the cable assembly.**
4. Mount cable assembly to the lift. Raise handle to the vertical position.
5. Attach adjustment chain to bolt on the plow attachment. Adjust the chain to it's tightest position. For final adjustment, tighten turnbuckle until slack is removed.
6. Assemble cover to baseplate. Secure with 1/4-20 screws.
7. Attachments are raised by pulling the handle toward the operator and resting on the ATV rack. Maximum lift is approximately 2 1/2" to 3" at the cable.

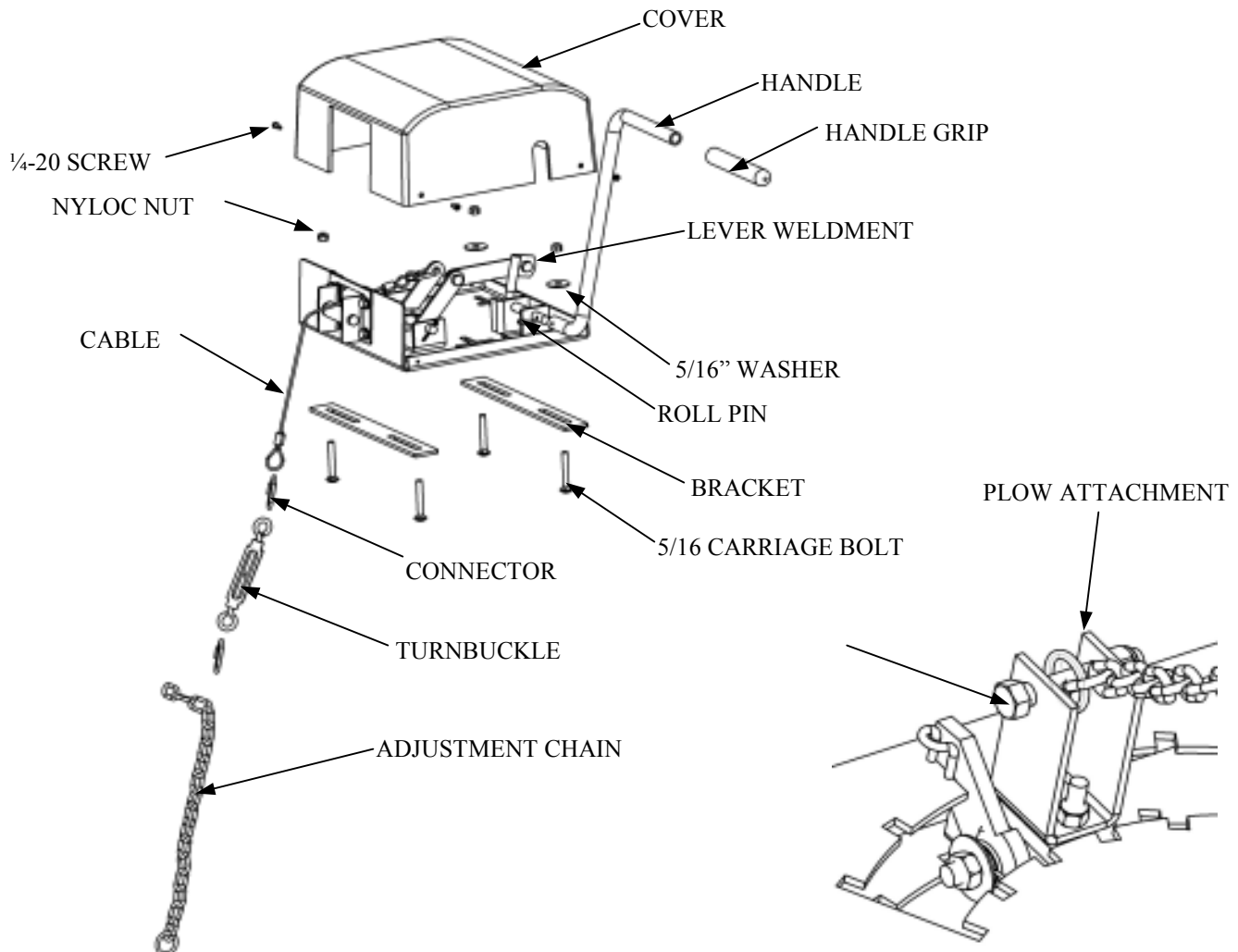

MANUAL LIFT ASSEMBLY

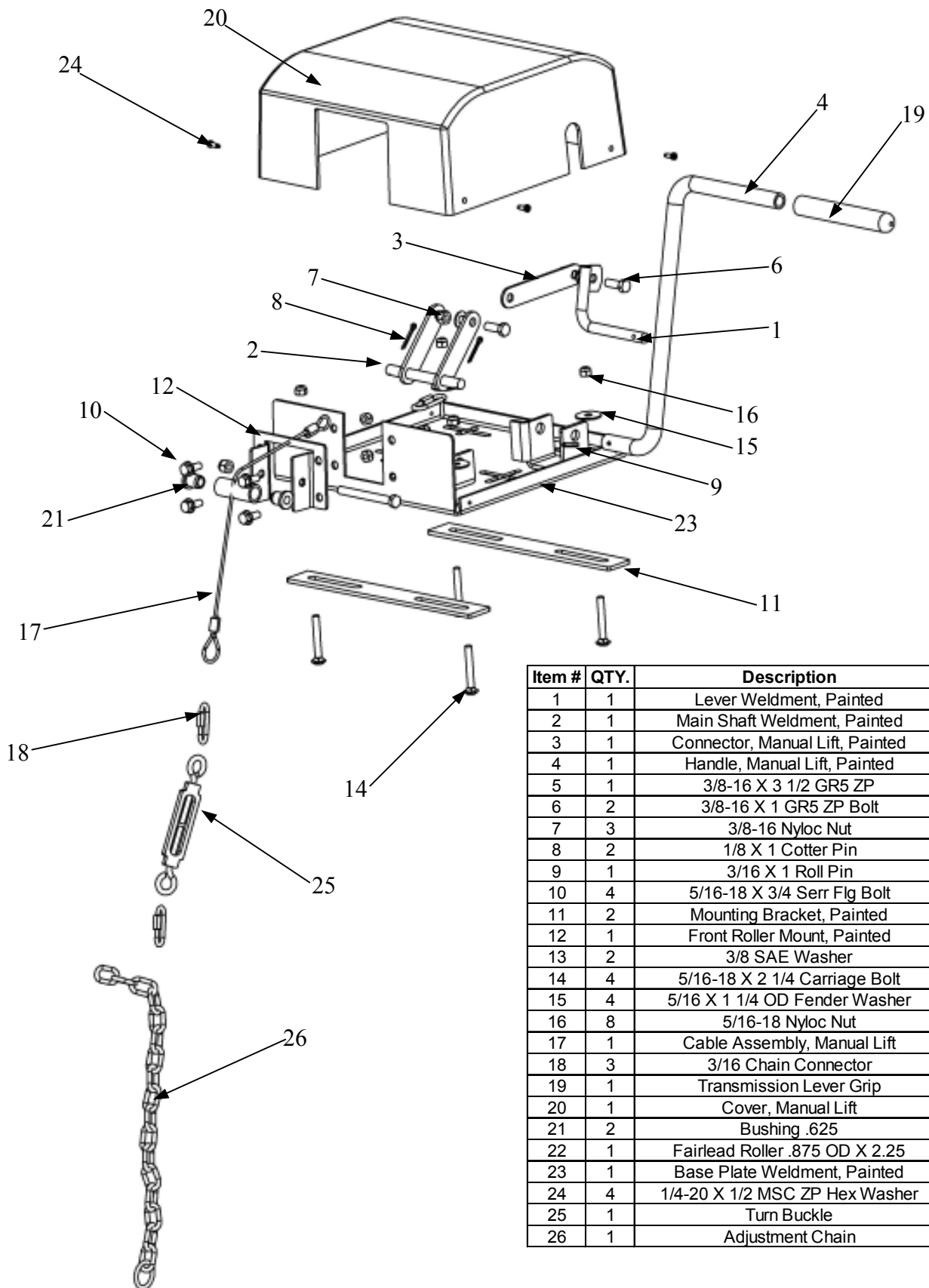

Item #	QTY.	Description	Part #
1	1	Lever Weldment, Painted	2818TK
2	1	Main Shaft Weldment, Painted	2822TK
3	1	Connector, Manual Lift, Painted	2792TK
4	1	Handle, Manual Lift, Painted	2820TK
5	1	3/8-16 X 3 1/2 GR5 ZP	NB649
6	2	3/8-16 X 1 GR5 ZP Bolt	NB604
7	3	3/8-16 Nyloc Nut	NB182
8	2	1/8 X 1 Cotter Pin	NB126
9	1	3/16 X 1 Roll Pin	NB123
10	4	5/16-18 X 3/4 Serr Flg Bolt	NB596
11	2	Mounting Bracket, Painted	2791TK
12	1	Front Roller Mount, Painted	2793TK
13	2	3/8 SAE Washer	NB272
14	4	5/16-18 X 2 1/4 Carriage Bolt	NB110
15	4	5/16 X 1 1/4 OD Fender Washer	NB579
16	8	5/16-18 Nyloc Nut	NB181
17	1	Cable Assembly, Manual Lift	2824
18	3	3/16 Chain Connector	ES077
19	1	Transmission Lever Grip	2427
20	1	Cover, Manual Lift	2794
21	2	Bushing .625	8048
22	1	Fairlead Roller .875 OD X 2.25	8005Z
23	1	Base Plate Weldment, Painted	2826TK
24	4	1/4-20 X 1/2 MSC ZP Hex Washer	NB114
25	1	Turn Buckle	2825
26	1	Adjustment Chain	2703



MANUFACTURING QUALITY LAWN CARE EQUIPMENT SINCE 1945

Owner's Manual

**Manual Lifter
2828**



IMPORTANT
Read and follow all
Safety Precautions
and Instructions
Before Operating this
Equipment.

MANUAL LIFT

**WHEN ORDERING PARTS, PLEASE HAVE THE
FOLLOWING INFORMATION AVAILABLE:**

- * **PRODUCT -** _____
- * **SERIAL NUMBER -** _____
- * **MODEL NUMBER -** _____
- TYPE -** _____
- * **PART NUMBER WITH PAINT CODE**
- * **PART DESCRIPTION**

TELEPHONE - 1-800-222-8183
FAX - 1-660-747-8650

SWISHER MOWER & MACHINE CO. INC.
1602 CORPORATE DRIVE
P.O. BOX 67
WARRENSBURG, MO 64093

swisherinc.com